



Mascord

ALAN MASCORD DESIGN ASSOCIATES, INC.

King's Hollow

21150A

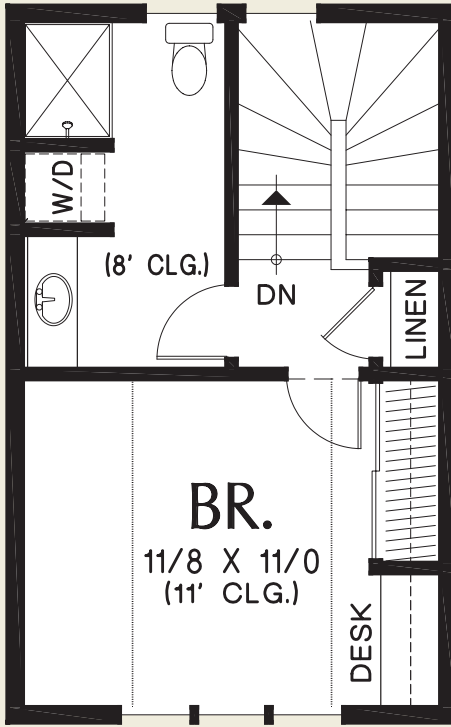
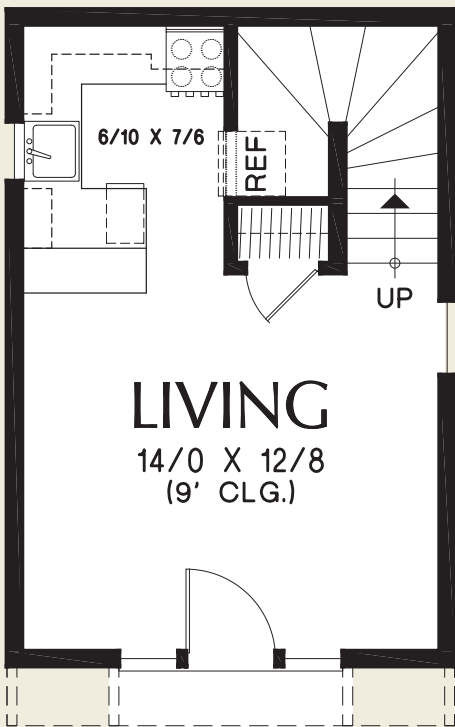

Upper Floor	298 Sq. Ft
Main Floor	330 Sq. Ft
Total Area	628 Sq. Ft

Width	Depth
15'-0"	24'-0"

Height (Main Flr to Peak): 25'-1"
(to Midpt of Roof): 21'-7"



ALAN MASCORD DESIGN ASSOCIATES, INC
2187 NW Reed St, Suite 100, Portland, OR 97210 · 503.225.9161

www.mascord.com

Copyright © 2019 Alan Mascord Design Associates, Inc.
All rights reserved.