

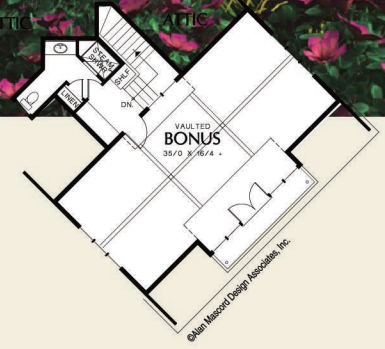

©Alan Mascord Design Associates, Inc.



Upper Floor	93 Sq. Ft
Main Floor	3913 Sq. Ft
Lower Floor	3025 Sq. Ft
Sub Total	7031 Sq. Ft
Bonus	+707 Sq. Ft
Bsmnt (Unfin.)	+897 Sq. Ft
Width	Depth
130'-9"	74'-9"
Height (Main Flr to Peak):	32'-0"
Plan Designed for Sloping Lots	



ALAN MASCORD DESIGN ASSOCIATES, INC
2187 NW Reed St, Suite 100, Portland, OR 97210 · 503.225.9161

mascord.com | houseplans.co