

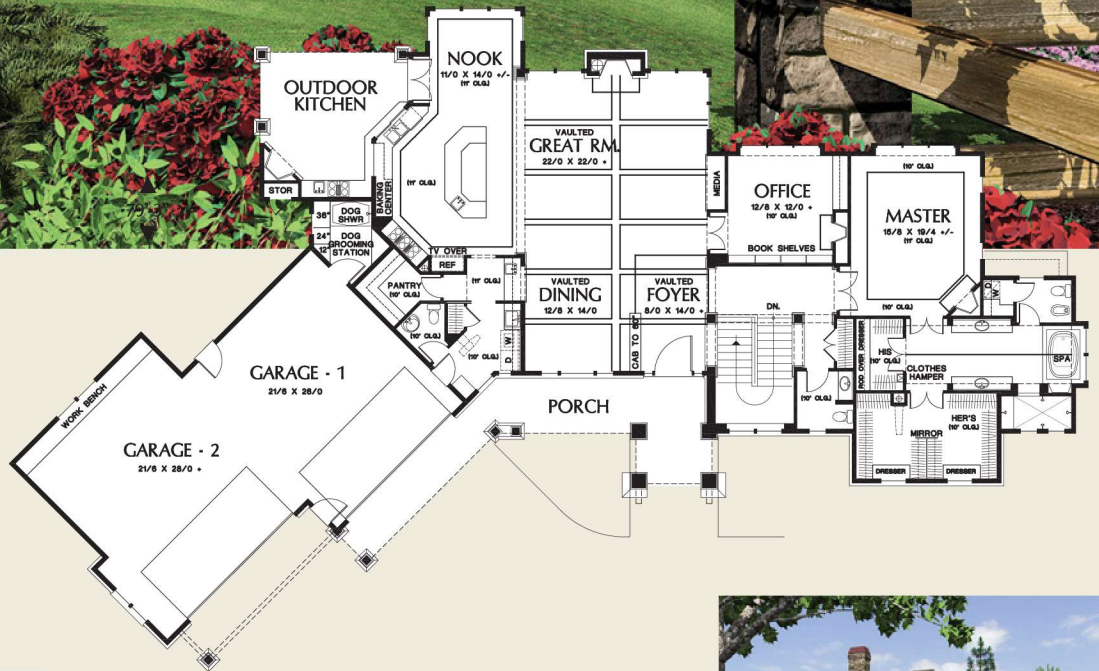

©Alan Mascord Design Associates, Inc.



**Total Area** 4732 Sq. Ft  
**Bsmnt (Unfin.)** +790 Sq. Ft

**Width** 130'-3"  
**Depth** 79'-3"

**Height** (Main Flr to Peak): 33'-10"  
(to Midpt of Roof): 21'-10"

Plan Designed for Sloping Lots



**ALAN MASCORD DESIGN ASSOCIATES, INC**  
2187 NW Reed St, Suite 100, Portland, OR 97210 · 503.225.9161

mascord.com | houseplans.co