

The Sterlington 2206C

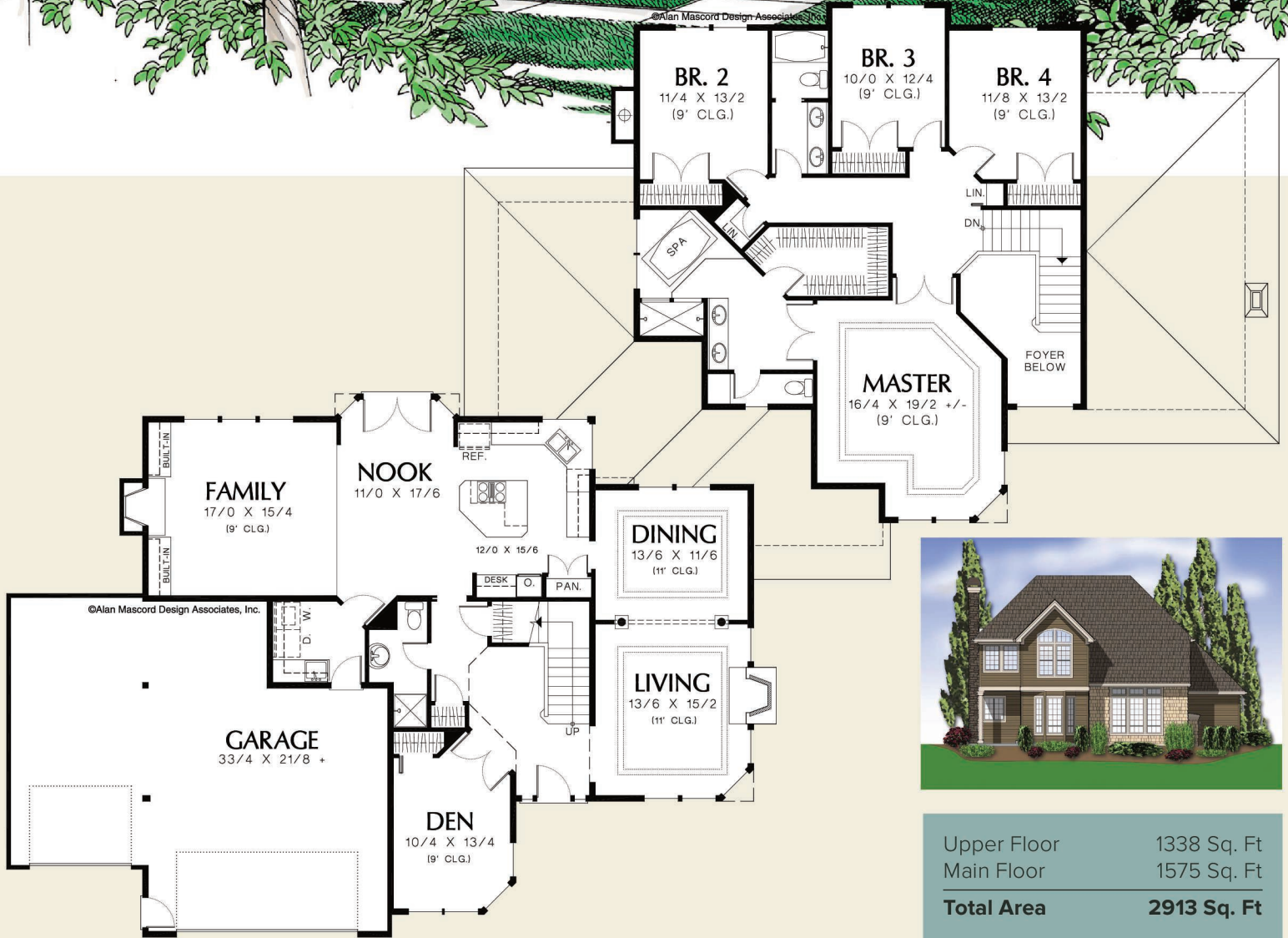

Upper Floor	1338 Sq. Ft
Main Floor	1575 Sq. Ft
Total Area	2913 Sq. Ft
Width	Depth
66'-0"	48'-0"
Height	(Main Flr to Peak): 26'-6"
	(to Midpt of Roof): 22'-4"

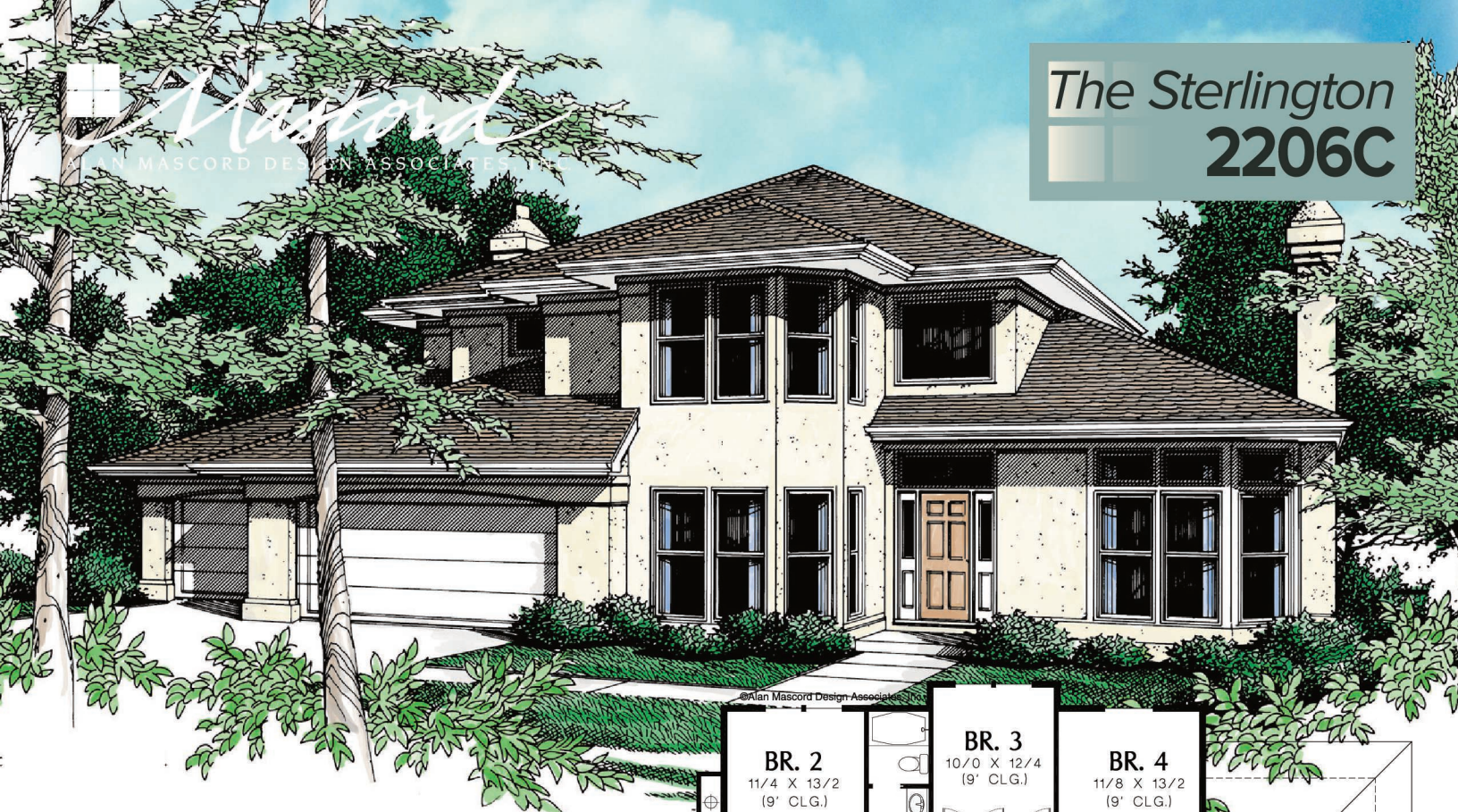

ALAN MASCORD DESIGN ASSOCIATES, INC
2187 NW Reed St, Suite 100, Portland, OR 97210 · 503.225.9161

mascord.com | houseplans.co